

S-502

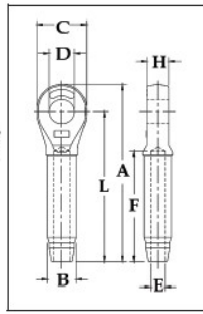

SISCA
SISTEMAS DE CARGA S.A. DE C.V.

S-502 Closed Socket Specifications												Press/ Die Data				
S-502 Stock No.	Rope Size (in.)	Weight Each (lbs.)	Before Swage Dimensions								Max. After Swage Dim. (in.)	Die Description	Stock No.		Side Load	
			A	B	C	D	E	F	H	L			500 1000 1500 Ton 5x7	1500 3000 Ton 6x12	1500 Ton 6x12	3000 Ton 6x12
			1039325	1/4	.33	4.28	.50	1.38	.76	.27			2.19	.50	3.50	.46
1039343	5/16	.75	5.42	.77	1.62	.88	.34	3.25	.68	4.50	.71	5/16 - 3/8 SOCKET	1192863	-	-	-
1039361	3/8	.72	5.42	.78	1.62	.88	.41	3.25	.68	4.50	.71	5/16 - 3/8 SOCKET	1192863	-	-	-
1039389	7/16	1.42	6.88	1.01	2.00	1.07	.49	4.31	.87	5.75	.91	7/16 - 1/2 SOCKET	1192881	-	-	-
1039405	1/2	1.42	6.88	1.01	2.00	1.07	.55	4.31	.87	5.75	.91	7/16 - 1/2 SOCKET	1192881	-	-	-
1039423	9/16	2.92	8.59	1.27	2.38	1.28	.61	5.38	1.14	7.25	1.16	9/16 - 5/8 SOCKET	1192907	-	-	-
1039441	5/8	2.85	8.59	1.27	2.38	1.28	.68	5.38	1.14	7.25	1.16	9/16 - 5/8 SOCKET	1192907	-	-	-
1039469	3/4	5.00	10.25	1.56	2.88	1.49	.80	6.44	1.33	8.63	1.42	3/4 SOCKET	1192925	-	-	-
1039487	7/8	6.80	11.87	1.72	3.12	1.73	.94	7.50	1.53	10.09	1.55	7/8 SOCKET	1192943	-	-	-
1039502	1	10.40	13.56	2.00	3.62	2.11	1.07	8.63	1.78	11.50	1.80	1 SOCKET	1192961	-	-	-
1039520	1-1/8	14.82	15.03	2.25	4.00	2.37	1.19	9.75	2.03	12.75	2.05	1-1/8 SOCKET	1192989	-	-	-
1039548	1-1/4	21.57	16.94	2.53	4.50	2.62	1.34	10.81	2.25	14.38	2.30	1-1/4 SOCKET	1193005	-	-	-
1039566	1-3/8	28.54	18.59	2.81	5.00	2.62	1.46	11.88	2.29	15.75	2.56	1-3/8 SOCKET	1193023	-	-	-
1039584	1-1/2	38.06	20.13	3.08	5.38	2.87	1.59	12.94	2.56	17.00	2.81	1-1/2 SOCKET	1193041	1191267	1193355	1195192
1039600	1-3/4	51.00	23.56	3.40	6.25	3.63	1.87	15.06	3.08	20.00	3.06	1-3/4 SOCKET	1193069	1191276	1195367	1195209
1042589	2	89.25	27.13	3.94	7.25	3.88	2.12	17.06	3.31	23.00	3.56	2 SOCKET	1193087	1191294	1195379	1195218