

Hook ID*	Dimensions (in.)													
	C	D	F	G	J	K	M	N	O	O2	Q	T	T2	AA
D	3.34	2.83	1.25	.73	.90	.63	.63	.36	.89	--	.75	.87	--	1.50
F	3.81	3.11	1.38	.84	.93	.71	.71	.42	.91	--	.91	.98	--	2.00
G	4.14	3.53	1.50	1.00	1.00	.88	.88	.55	1.00	--	1.13	1.03	--	2.00
H	4.69	3.97	1.63	1.13	1.13	.94	.94	.58	1.09	--	1.25	1.16	--	2.00
I	5.77	4.81	2.00	1.44	1.47	1.31	1.31	.72	1.36	1.00	1.56	1.53	1.50	2.50
J	7.37	6.27	2.50	1.81	1.75	1.66	1.66	.90	1.61	1.31	2.00	1.96	1.88	3.00
K	9.07	7.45	3.00	2.25	2.29	1.88	1.63	1.11	2.08	1.81	2.44	2.47	2.25	4.00
L	10.08	8.30	3.25	2.59	2.50	2.19	1.94	1.27	2.27	2.00	2.84	2.62	2.31	4.00
N	12.53	10.30	4.25	3.00	3.30	2.69	2.38	1.56	3.02	2.75	3.50	2.83	2.56	5.00
O	14.06	13.62	5.00	3.62	4.00	3.00	3.00	1.75	3.25	--	3.50	3.44	--	6.50
P	18.19	14.06	5.38	4.56	4.25	4.00	3.19	2.00	3.00	--	4.50	3.88	--	7.00
S	20.12	15.44	6.00	5.06	4.75	4.50	3.25	2.18	3.38	--	4.94	4.75	--	8.00
T	23.72	18.50	7.00	6.00	5.75	5.50	3.91	2.53	4.12	--	5.69	5.69	--	10.00

S-322CN / S-322AN

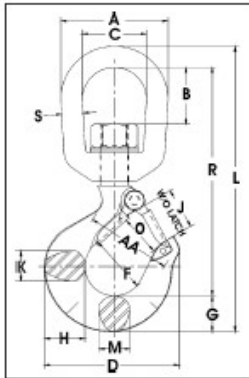

Working Load Limit (t)*		S-322CN Stock No.	S-322AN Stock No.	Weight Each (lbs.)	Dimensions (in.)														Rep. Latch Stock No.	
Carbon	Alloy				A	B	C	D	F	G	H	J	K	L	M	O	R	S		AA
3/4	1	1048600	1048804	.75	2.00	.82	1.25	2.86	1.25	.73	.81	.93	.63	5.66	.63	.93	4.55	.38	1.50	1096325
1	1-1/2	1048609	1048813	1.25	2.50	1.31	1.50	3.15	1.38	.84	.94	.97	.71	6.71	.71	.97	5.37	.50	2.00	1096374
1-1/2	2	1048618	1048822	2.25	3.00	1.50	1.75	3.59	1.50	1.00	1.16	1.06	.88	7.75	.88	1.06	6.12	.63	2.00	1096421
2	3	1048627	1048831	2.30	3.00	1.50	1.75	4.00	1.62	1.13	1.31	1.19	.94	8.25	.94	1.16	6.50	.63	2.00	1096468
3	5	1048636	1048837	4.96	3.50	1.64	2.00	4.84	2.00	1.44	1.63	1.50	1.31	9.69	1.13	1.41	7.50	.75	2.50	1096515
5	7	1048645	1048854	10.29	4.56	2.29	2.50	6.28	2.50	1.81	2.06	1.78	1.66	12.47	1.44	1.69	9.63	1.00	3.00	1096562
7-1/2	11	1048654	1048865	16.18	5.00	2.53	2.75	7.54	3.00	2.25	2.63	2.41	1.88	14.75	1.63	2.22	11.37	1.13	4.00	1096609
10	15	1048663	1048877	23.25	5.62	2.48	3.12	8.34	3.25	2.59	2.94	2.62	2.19	16.40	1.94	2.41	12.25	1.25	4.00	1096657
15	22	1048672	1048886	47.00	7.10	3.76	4.10	10.34	4.25	3.00	3.50	3.41	2.69	21.34	2.38	3.19	16.71	1.50	5.00	1096704
--	30	--	1025688	70.50	7.10	3.76	4.10	13.62	5.00	3.61	4.63	4.00	3.00	23.25	3.00	3.25	18.01	1.50	6.50	1093716